



Hornbeam Square, London, E3

BUTLER & STAG



Guide Price £475,000 - £525,000
Enjoying an attractive canal side setting on the banks of the Hertford Union Canal, Rowan House presents an unparalleled opportunity for those seeking refined urban living. Overlooking the picturesque Victoria Park, this 2-bedroom apartment combines modern comfort with breath-taking views, promising a lifestyle of both tranquillity and convenience.



Leasehold

- Positioned On The Banks Of The Hertford Union Canal
- Private Balcony
- Mile End & Bethnal Green Station Close By
- Chain Free
- Full Frontal Views Of The Award Winning Victoria Park
- Off Street Parking - Allocated Space
- Two Bedroom Apartment
- Third Floor

Situated adjacent to Victoria Park, residents enjoy easy access to lush greenery, jogging trails, and recreational facilities, offering a serene retreat amidst the bustling city.

Dual aspect windows offer stunning vistas of Victoria Park and the surrounding skyline, providing a constant connection to nature and urban life.

With convenient access to public transportation, Rowan House connects you effortlessly to the city's cultural, dining, and entertainment hubs.

Whether relaxing in the comfort of your private balcony overlooking the park or exploring the vibrant neighborhood, Rowan House sets a new standard for luxurious city living.





Rowan House, Hornbean Square, E3

Approx. Gross Internal Area 60 Sq M (645 Sq Ft)

BUTLER & STAG

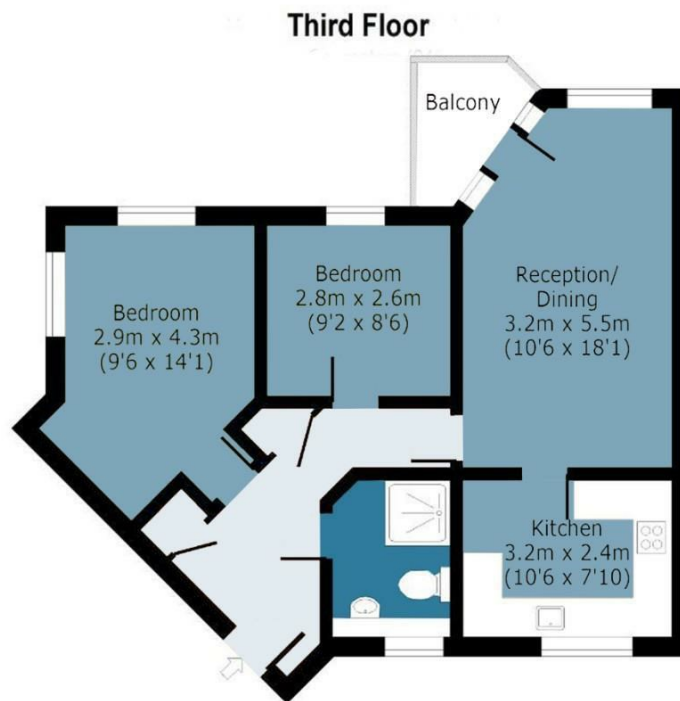

Measurements are approximate and for illustration purposes only. While we do not doubt the accuracy and completeness, we advise you conduct a careful independent assessment of the property to determine monetary value.
© @modephoto.uk www.modephoto.co.uk

IMPORTANT NOTICE - These particulars have been prepared in good faith and they are not intended to constitute part of an offer or contract. We have not performed a structural survey on this property and the services, appliances and specific fittings have not been tested. All photographs, measurements, floor plans and distances referred to are given as a guide and should not be relied upon.

BUTLER & STAG

☎ 020 8102 1236

🏠 508 Roman Road, Bow, London, E3 5LU

✉ bow@butlerandstag.com

www.butlerandstag.uk